



2020-2021 Registration Guide
Kaohsiung Medical University, Taiwan

Kaohsiung Medical University

International Student

Registration Guide



Table of Contents

REGISTRATION PROCEDURES	1
TIME SCHEDULE OF REGISTRATION	2
FLOW CHART OF REGISTRATION PROCEDURES	3
KMU CAMPUS MAP	5
<i>Important buildings for registration</i>	<i>5</i>
<i>KMU Campus Map with Surroundings</i>	<i>6</i>
<i>Office sites for the registration procedures</i>	<i>7</i>
STEPS OF REGISTRATION	9
<i>Fill in basic information on Wac system</i>	<i>9</i>
<i>Arrive in Taiwan/campus</i>	<i>10</i>
<i>Dormitory information</i>	<i>11</i>
<i>Registration procedures(checklist).....</i>	<i>11</i>
<i>Health Exam</i>	<i>11</i>
<i>Print the tuition bill and finish payment</i>	<i>12</i>
<i>Verification of academic documents and Completion of registration</i>	<i>13</i>
<i>Application for Alien Resident Certificate</i>	<i>14</i>
<i>Activate a post office account</i>	<i>15</i>
<i>Course selection and Utilization of student information system</i>	<i>15</i>
<i>Other information for freshmen</i>	<i>16</i>
LIVING INFORMATION IN KMU	17
CLIMATE	18
VOLTAGE	18
TAIWAN PLUG ADAPTERS AND OUTLET SHAPES.....	19
TIME ZONE	19
CURRENCY EXCHANGE.....	19
PHONE NUMBERS	19
TRAVEL INFORMATION.....	20
MRT INFORMATION- KAOHSIUNG RAPID TRANSIT CORPORATION	20
EMERGENCY CONTACT	20
SURROUNDING AREA	21
SURROUNDING AREA MAP	23
ACADEMIC CALENDER.....	24





Registration Procedures





Time Schedule of Registration

Issue	Program	Time	PS
Fill in basic information on wac system	M.S. / Ph.D	Jul. 6 ~ Jul.31	This must be completed before registration process
	Post Baccalaureat	Jul. 16 ~ Jul.31	
	B.S.	Aug. 10 ~ Aug. 28	
Apply for dorm	M.S. / Ph.D	Jul. 16 ~ Jul. 22	
	Post Baccalaureat	Jul. 16 ~ Jul. 22	
	B.S.	Jul. 16 ~ Jul. 22	
Arrive in Taiwan/Campus	M.S. / Ph.D	before Aug. 3*	For the newest timing, please follow the instructions of CDC, Taiwan. <u>(We'll inform you with the latest news via email)</u>
	Post Baccalaureat	before Aug. 3*	
	B.S.	before Aug. 28*	
Health Exam	M.S. / Ph.D	Jul. 13 ~ Aug. 3*	
	Post Baccalaureat	Aug. 3*	
	B.S.	Aug. 28, Aug. 29, Aug. 31	
Print the tuition bill and finish payment	M.S. / Ph.D	Jul. 13 ~ Aug. 3*	
	Post Baccalaureat	Jul. 23 ~ Aug. 3*	
	B.S.	Aug. 21 ~ Aug. 28*	
Have the academic documents verified	M.S. / Ph.D	Aug. 3*	
	Post Baccalaureat	Aug. 3*	
	B.S.	Aug. 31*	
Apply for Alien Resident Certificate	M.S. / Ph.D	within 15 days after arriving Taiwan*	students who need to do 14 days quarantine can finish this procedure after the quarantine period.
	Post Baccalaureat		
	B.S.		
Activate a post office account	M.S. / Ph.D	Aug. 17 ~ Aug. 21	
	Post Baccalaureat	Aug. 17 ~ Aug. 21	
	B.S.	Sep. 14 ~ Sep. 18	





Flow Chart of Registration Procedures

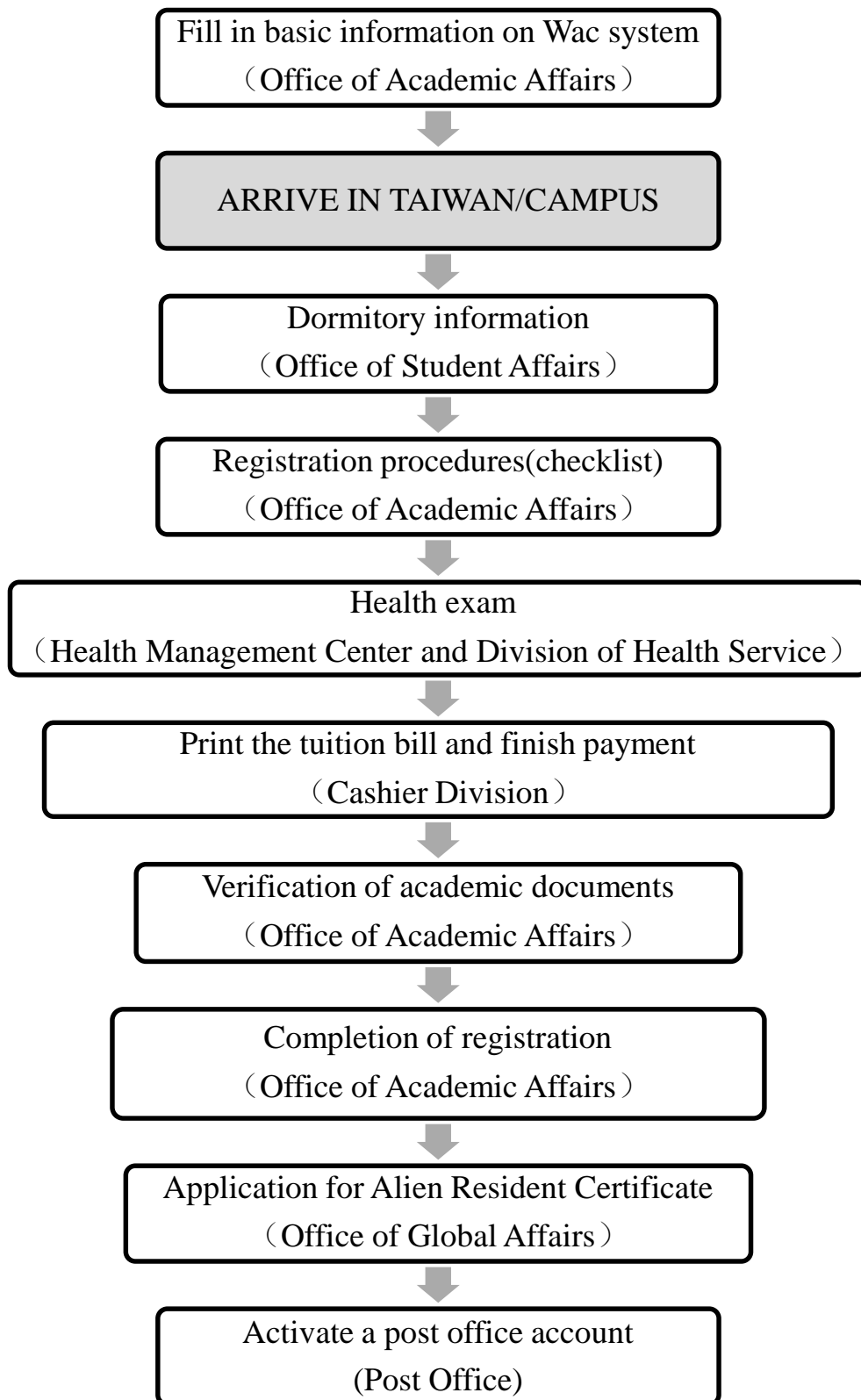



2020-2021 Registration Guide
Kaohsiung Medical University, Taiwan

Course selection

(Office Of Academic Affairs and affiliated departments)



Utilization of students information system
(Office of Library and Information Services, affiliated
departments)





KMU Campus Map

Important buildings for registration

Kaohsiung Medical University

1. Gate
2. Li-Hsueh Building
(Office of Academic Affairs / Office of Global Affairs)
3. Zihciang Building
(Health Management Center)
4. Chi-Shih Building
(Division of Health Service / Post Office)
5. Tzyou 1st Rd.
6. Shih-Chuan 1st Rd.
7. Tongmeng 1st Rd.

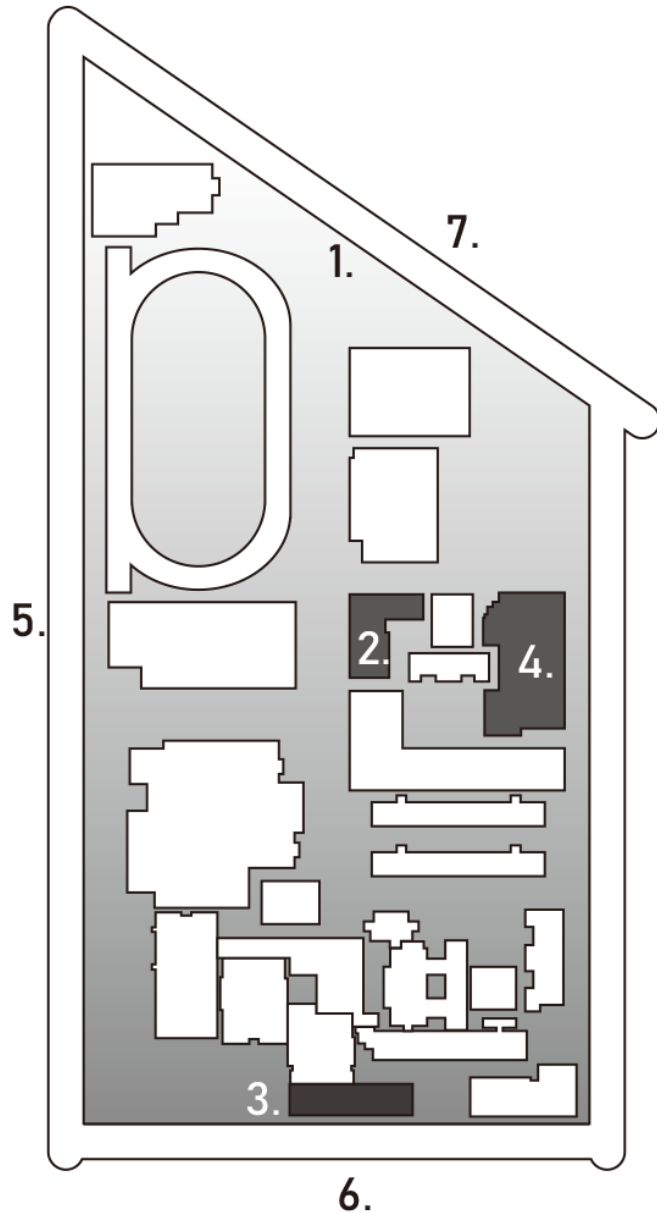



KMU Campus Map with Surroundings

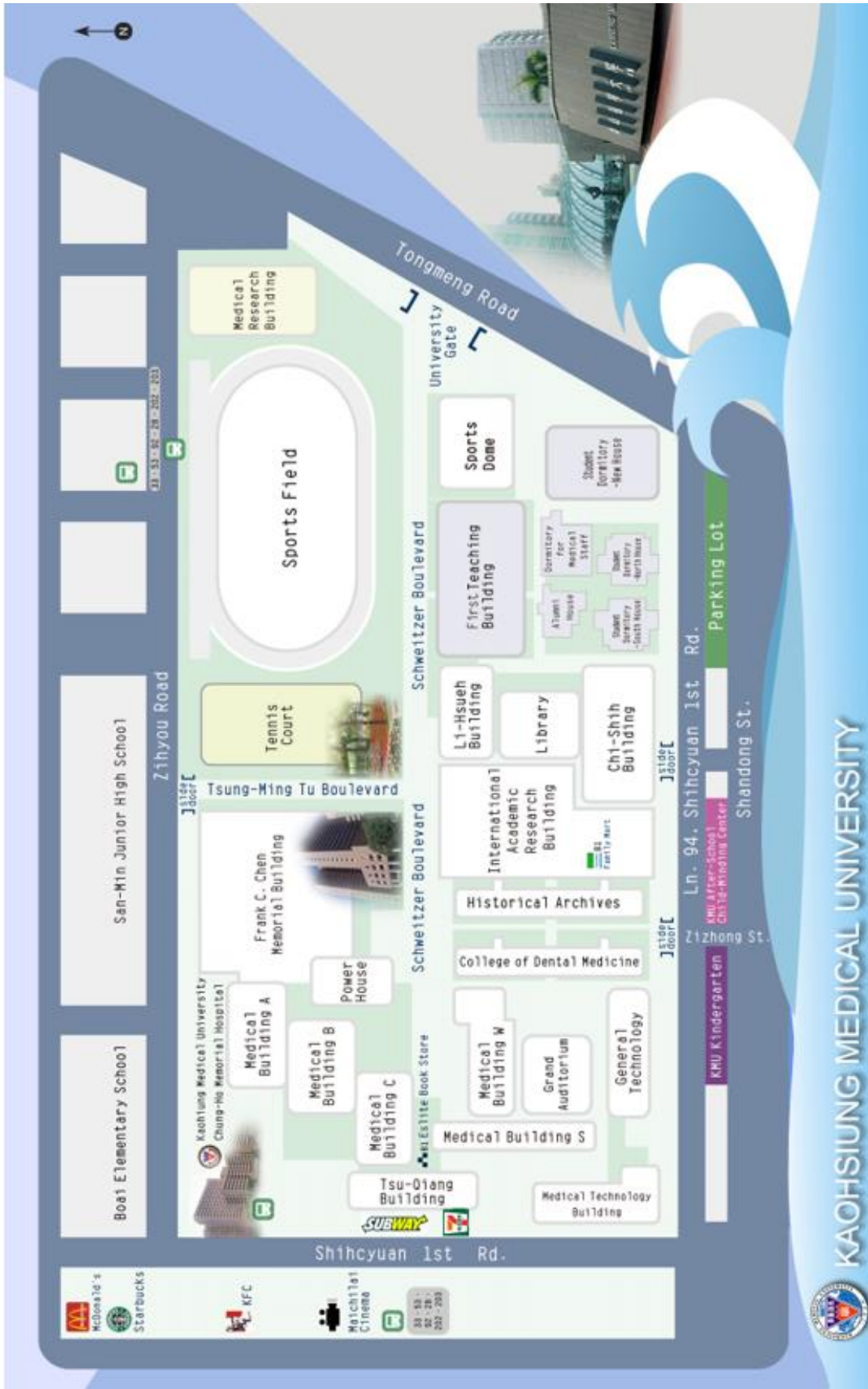



Office sites for the registration procedures

**Li-Hsueh Building
1F**

- 1. Entrance
- 2. Stairs
- 3. Elevator
- 4. Cashier
Division
- 5. General
Affairs

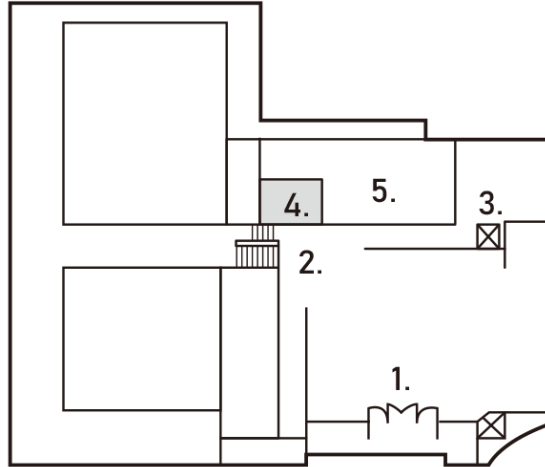

**Li-Hsueh Building
2F**

- 1. Stairs
- 2. Elevator
- 3. Office of
Academic
Affairs.
(Division of
registration and
curriculum)

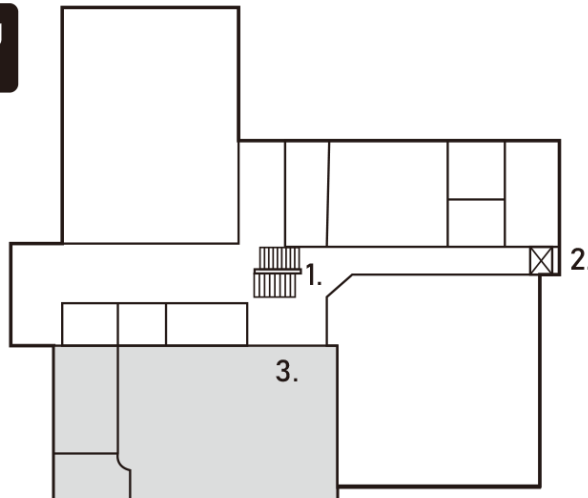



**Li-Hsueh Building
4F**

- 1. Stairs
- 2. Elevator
- 3. Office of Global Affairs.
(Division of Student Exchange)

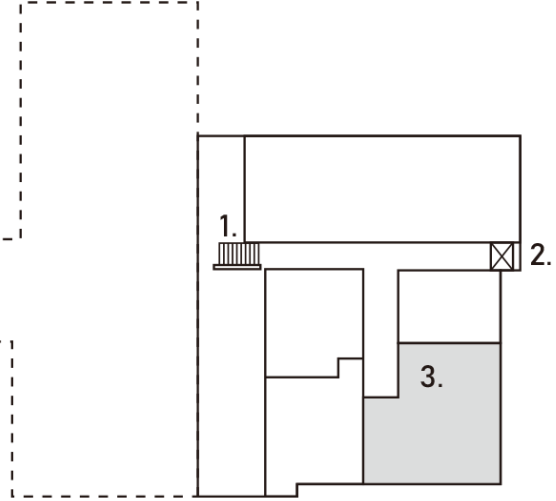

**Chi-Shih Building
1F**

- 1. Stairs & Elevator
- 2. Division of Health Service
- 3. Post Office

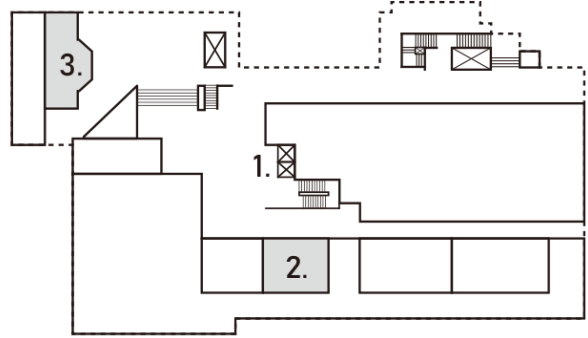

Kaohsiung Medical University Chung-Ho Memorial Hospital

- 1. Hospital Building A
- 2. Hospital Building B
- 3. Hospital Building C
- 4. Zihciang Building
(Health Management Center)
- 5. Medical Technology Building
- 6. Tzyou 1st Rd.
- 7. Shih-Chuan 1st Rd.

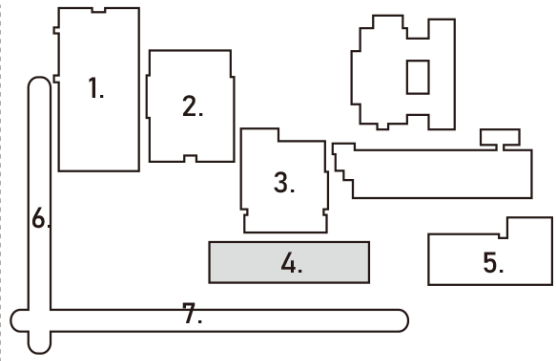



Steps of registration

Fill in basic information on Wac system

1. Go to Wac system: <https://wac.kmu.edu.tw/>
2. Login ID: your student ID number
Login password: The default would be your birthday (format: yymmdd; Taiwan year). For example, if you were born in January 1st, 1983, then your default password will be 720101 (which means 1983-1911=72).
3. [Chinese Vision]: 學生→D. 1. 教務資訊→D. 1. 01 新生學生基本資料設定
[English Vision]: Student Service→Freshmen Fill in Basic Information
4. Type your personal information in the system

NOTICE How to find my student ID number?

You can find it here: <https://wac.kmu.edu.tw/qur/qurq0020.php>

Master program and PhD program students can search it since Jul. 6.

Post Baccalaureat Medicine students' Stu. ID will be published on Jul. 6..

Undergraduate students' Stu. ID will be published on Aug. 12.

※Please finish it before you arrive in Taiwan.

※If you have any question about this, please ask the Division of Registration & Curriculum. (**Contact person**: Ms Wu:skycaca@kmu.edu.tw)





Arrive in Taiwan/Campus

According to the policies of Taiwan CDC, government will release border restrictions by steps. Students who belongs to the permitted countries should follow 2 SOP to enter Taiwan:

[SOP 1-before arriving Taiwan]

1- Report flight information to university.

※Please follow the message sent from Global Affairs Office of KMU and finish this procedure on time.

2- Get VISA approval.

[SOP2- after arriving Taiwan]

1- Pass border control examination.

2- Complete Check-in processes.

3- Take Epidemic Prevention Taxi (Rental cars) to the location for 14 days quarantine.

※KMU will guide you to finish those steps.

※Instruction mark of Epidemic Prevention Taxi (Rental cars):



※Foreigners In Taiwan 24hr Call: 0800-024-111





Dormitory information

Due to the reconstruction of dormitory, students will most likely need to rent outside the campus.

1. The Office of General Affairs is still working on off-campus dormitory. For the latest updates, please go to the website: <https://reurl.cc/ZLQEW> or contact Mr. Chen (m867015@kmu.edu.tw).
2. If there are off-campus dormitory available, the related application procedure will be announced on the website: <https://reurl.cc/QK7O9> or contact Ms Hsieh (peicih@kmu.edu.tw).
3. If you want to be on the alternative list of Dorm, please contact Sally(sallyiean@kmu.edu.tw) and finish the enrollment before **Jul. 22.**
4. For students who live outside campus, please send your address to Sally (sallyiean@kmu.edu.tw) before **Sep. 14 .**

Registration procedures(checklist)

Please go to the Office of Academic Affairs (division of registration and curriculum) and take a checklist of registration procedures. You will get student ID card after finishing the procedures..

Health Exam

1. Students are required to refrain from eating at least 8 hours before the medical check up.
 2. Students are required to prepare **fees of NT580** upon the Health Exam and go to the Health Management Center of KMU Hospital to do the medical check up.
 3. Students will receive the receipt for Health Exam from the hospital authorities.
 4. Please bring the receipt to the Division of Health Service and get a stamp on the checklist of registration procedures.
 5. Please keep the receipt for at least 6 months
- ※If you have any question about this, please ask the Division of Health Service.

Contact person: Ms Zhuang ping@kmu.edu.tw





Print the tuition bill and finish payment

<Print the tuition bill>

The tuition fee invoice/payment slip is available for print on the internet, you can find the information of payment notice here: <https://oga.kmu.edu.tw/index.php/zh-TW/department-navigation/cashier-section/tuition-fee>

<Finish payment>

1. **The process for the Elite(培英), MOFA and MOST scholarship students**
Students will pay the tuition by the installment plan for the monthly stipend. We will get the name list of scholarship recipient after the beginning of Sep. We will give you more information at that time.

2. **The process for the MOE and KMU scholarship students**

- (1) Print the tuition fee bill by yourself.
- (2) Come to OGA (Office of Global Affairs) and sign a receipt that can prove you successfully get the scholarship.
- (3) The OGA put the stamp on your tuition fee bill and calculate how much you need to pay.
- (4) Bring your bill to the division of cashier to finish your payment and you will get the receipt of the tuition fee.
- (5) If you have any question of payment deadline, please contact Sally, staff of Office of Global Affairs (sallyiean@kmu.edu.tw) directly.

3. **The process for the ICDF scholarship students**

Please ask the program manager of the department. The Program in Tropical Medicine: mstm@kmu.edu.tw





Verification of academic documents and Completion of registration

1. Students who fail to submit the following required documents during registration will have their recognized student status cancelled.
 - (1) Acceptance Notice
 - (2) Passport
 - (3) Original diploma and transcript verified by Taiwan Overseas Representative office
 - (4) Checklist of registration procedures
 - (5) Receipt of the tuition fee

2. After finishing the procedures, you will receive the student ID card.

※If you have any question about this, please ask the Division of Registration & Curriculum.

(**Contact person:** Ms Wu: skycaca@kmu.edu.tw)





Application for Alien Resident Certificate

*A foreign national who enters with a residency visa, shall apply for an ARC within 15 days after entry into Taiwan. **But as the policies of Taiwan CDC, students could apply for Alien Resident Certificate after finishing the 14 days quarantine in 2020 academic year.***

A foreign national who enters with a residency visa or obtains a residency visa in Taiwan shall apply for an ARC within 15 days or the over-due penalty will be NT\$ 2,000-10,000.
A foreign national who applies for changing his/her domicile or his/her place of employment during the period of his/her residency, he/she shall apply for registering the change within 15 days or the over-due penalty will be NT\$ 2,000-10,000.

ARC application guideline:

※ Receiving units: The Kaohsiung NIA's service center. (office hour: Mon.- Fri., 8:00-17:00) 5F, No.6, Zhengnan Street, Lingya District, , Kaohsiung City

※ Required documents (verify the original and take its copy).

1. A completed application form:
http://ciae2.kmu.edu.tw/images/doc_download_Arrival_in_Taiwan/ARC.pdf
2. A passport with resident visa.(A foreign national applying for modifications in the reasons for residency pursuant to Paragraph 2 of Article 23 of the Act, is exempt from being examined for an entry visa)
3. Related documents for residency (Studying): A Student ID card with a stamp from Office of Academic Affairs.
4. One 2''x 2'' colored photo, front head and shoulder, taken within six months.
5. A foreign national who applies for an ARC reissuing shall submit Declaration of Loss of ARC or a Crime Report

※ Fees: NT1,000.

※ Processing time: 10 working days.

NOTICE Please keep the receipt after you finish the payment, and hand in it when you pick up ARC card.

※If you have any question about this, please ask the staff of Global Affairs Office.

Contact person: Sally Huang sallyiean@kmu.edu.tw





Activate a post office account

1. Prepare the ARC, Passport, Personal Stamp and NTD 100 to the post office on campus.
2. Since the post office bank account can only be applied after the acquisition of ARC, students are required to carry enough cash to pay the mandatory fees.

Course selection and Utilization of student information system

1. The 2020 Academic Calendar (Eng-Vision): Page 24.
2. Please check this website for Course selection:
<http://academic.kmu.edu.tw/index.php/en-GB/online-service>
3. Course registration system: <http://wac.kmu.edu.tw/>
4. You will need student number and password to log into the system and register the courses. However, according to the Division of Registration and Curriculum, the student number will not be ready until 6th July and 13th Aug. **For password, the default would be your birthday (format: yymmdd; Taiwan year). For example, if you were born in January 1st, 1983, then your default password will be 720101 (which means 1983-1911=72).**
5. Date of Course Selection:

Preliminary course selection (預選課時間):

2020/08/13(Thu.) 00:00 to 2020/08/26(Wed.) 23:59

First stage course-adding/dropping (第一次加退選):

2020/08/31(Mon.) 00:00 to 2020/09/04(Fri.) 11:59

Second stage course-adding/dropping (第二次加退選):

2020/09/04(Fri.) 20:00 to 2020/09/14(Mon.) 11:59

※If you have any question about the course selection, please ask the Division of Registration & Curriculum.

(Contact person: Ms Wu:skycaca@kmu.edu.tw)

※If you have any question about the student information system, please ask the office of Library and Information Services by mail olis@kmu.edu.tw.





Other information for freshmen

1. Visa

- Please contact Taiwan Embassy or Taipei Economic and Cultural Center in your country directly.
- Please make sure the type of your visa is **Resident VISA**, NOT Tourist VISA.

2. Pick-up service

The Global Affaris Office do NOT have Pick-up Service.

3. Checklist for Students' Expenditure Upon the Arrival in Taiwan

Items	Amount (NTD)
*Health exam	580
*ARC Application (For those who hold resident visa)	1,000
*Tuition and miscellaneous fees	Depends on one's affiliated department
*Accommodation fees	Depends on the situation
Medical Insurance (For those without authenticated overseas insurance)	3,000-4,000
*Textbook, stationary, others	2,000-4,000
Daily Expenses	Approximately 7,000 per month
Epidemic Prevention Taxi (Rental cars)	2,660(From Taiwan Taoyuan International Airport to Kaohsiung)
Rent for 14 days quarantine	1,200~2,300 per day.

*mandatory item





Living information in KMU





Climate

Taiwan enjoys warm weather all year round. Weather conditions fluctuate during spring and winter, while in summer and autumns, the weather is relatively stable. The annual average temperature is at 22 degrees Celsius, a comfortable condition, with the lowest temperatures on the lowlands generally ranging from 12 to 17 degrees Celsius (54-63 Fahrenheit). Therefore, with the exception of a few mountainous areas where some traces of snow can be found during winter, no snow can be seen in Taiwan. During the raining season (March to May), continuously drizzling rain will sometimes fall on Taiwan. When visiting Taiwan during this period, remember to carry an umbrella at all time. Although it might seem romantic to have a stroll in the rain, it is no fun to travel when you're soaking wet. During the summer time (June to August), typhoons sometimes approach or hit the country.

Voltage

Electricity in Taiwan is 110 volts, alternating at 60 cycles per second. If you come to Taiwan with a device that does not accept 110 volts at 60 Hertz, you will need a voltage converter. There are three main types of voltage converter. Resistor-network converters will usually be advertised as supporting something like 50-1600 watts. They are light-weight and support high-wattage electrical appliances like hair dryers and irons. However, they can only be used for short periods of time and are not ideal for digital devices. Transformers will have a much lower maximum Watt rating, usually 50 or 100. Transformers can often be used continuously and provide better electricity for low wattage appliances like battery chargers, radios, laptop computers, cameras, mp3 players and camcorders. However, they are heavy because they contain large iron rods and lots of copper wire. Some companies sell combination converters that include both a resistor network and a transformer in the same package. This kind of converter will usually come with a switch that switches between the two modes. If you absolutely need both types of converter, then this is the type to buy.



Taiwan Plug Adapters and Outlet Shapes



Outlets in Taiwan generally accept this type of plug Flat blade plug

If your appliance has a different shape of plug, you may need a plug adapter.

Time Zone

UTC +8:00

Currency Exchange

If you want to exchange currency, you need to bring the required certificates to banks or post office

1. Required Certificates: Passport
2. Commission charge and the USD/NT, EUR/NT, or JPY/NT exchange rates will be a little bit different from different banks and post office.

Phone Numbers

There are three telecommunications companies: Chunghwa Telecom, Taiwan mobile, Far East Tone in Arrivals Hall, Kaohsiung International Airport.

Or you can go to Telecom Service Center near Campus below:

Name	Address	Business hours
Chunghwa Telecom	No.80, Tzyou 1st Road, Kaohsiung City	11:30-21:00
Taiwan Mobile	No.107, Tzyou 1st Road, Kaohsiung City	11:30-21:00
Far East Tone	No.119, Tzyou 1st Road, Kaohsiung City	11:30-21:00
T Star	No.109, Tzyou 1st Road, Kaohsiung City	11:30-21:00
Asia Pacific Telecom	No.121, Tzyou 1st Road, Kaohsiung City	10:30-21:00

Required documents for application: If you are a student from China, please bring your **Exit & Entry Permit**. If you are not a student from China, please bring your **passport**.



Travel Information

Please go to this official website to get more information: <https://khh.travel>

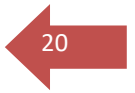

MRT Information- Kaohsiung Rapid Transit Corporation

Please go to this official website to get more information: <https://www.krtco.com.tw/>

Emergency Contact

1. Police Station: 110
(In case you are in a car accident, please do not move the vehicles for keeping the science intact.)
2. Fire Bureau: 119
3. Campus Security Center: 07-3220809(24H)
4. KMU Hospital Emergency Room: 07-3208249



Surrounding Area

1. Where can I get food?

On campus, you can go to student restaurant, which located on the B1 of International Academic Research Building. If you want to find restaurant out of campus, you can find it easier in the place A~E as below.

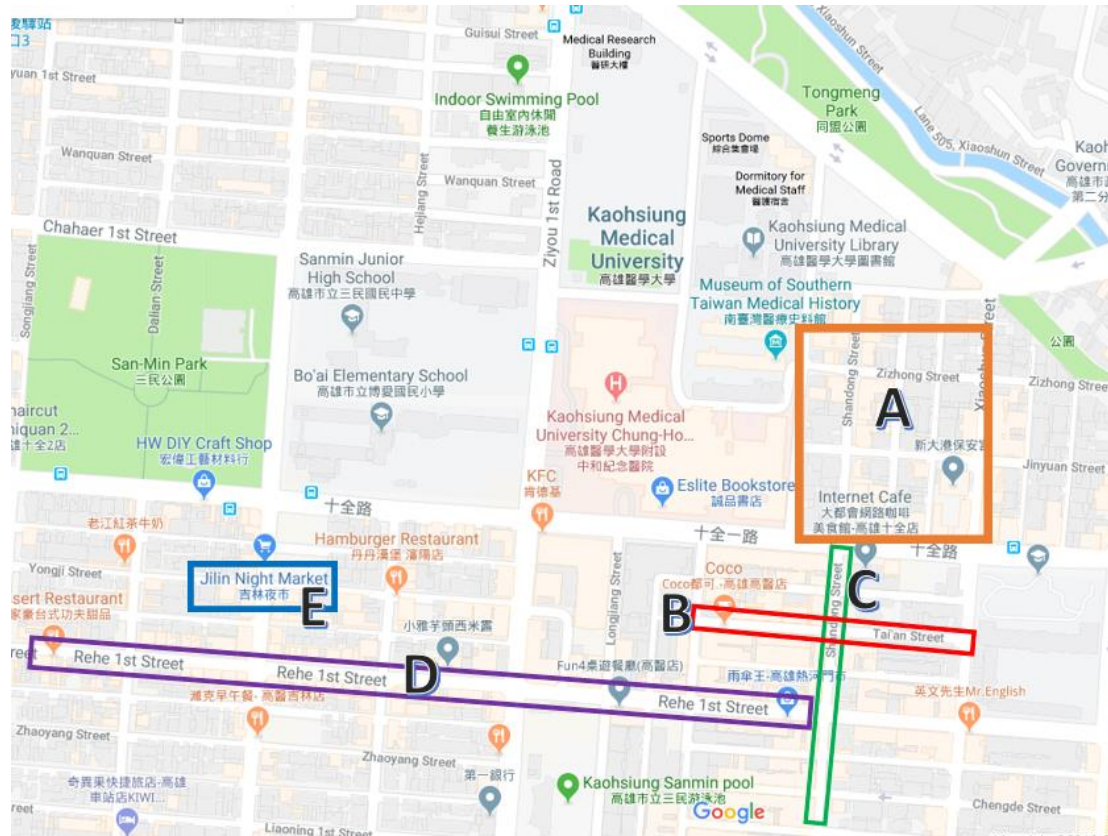

- A: East Gate Area(東側門區)
- B: Tai-An Street(泰安街)
- C: Shan-Dong Street(山東街)
- D: Re-He Street(熱河街)
- E: Jilin Night Market(吉林夜市)



2. Where can I buy daily supplies?





■ Supermarket/ Grocery Supplier

Store Name	Store Brand	Branch Address which Nearest with Campus
小北百貨 SHOW BA		The corner of Tzyou Rd. and Jiuru Rd. (New Opening) 24HR
全聯福利中心 Pxmart		No.229, Bo'ai 1st Rd., Sanmin Dist., Kaohsiung City 08:00~23:00

■ Cosmeceutical shops

Store Name	Store Brand	Branch Address which Nearest with Campus
屈臣氏 Watsons		No.80, Ziyou 1st Rd., Sanmin Dist., Kaohsiung City 10:00~23:00

■ Convenience Store (24HR)

Store Name	Store Brand
7-Eleven	
全家 FamilyMart	
萊爾富 Hi-Life	
OK Mart	





Surrounding Area Map

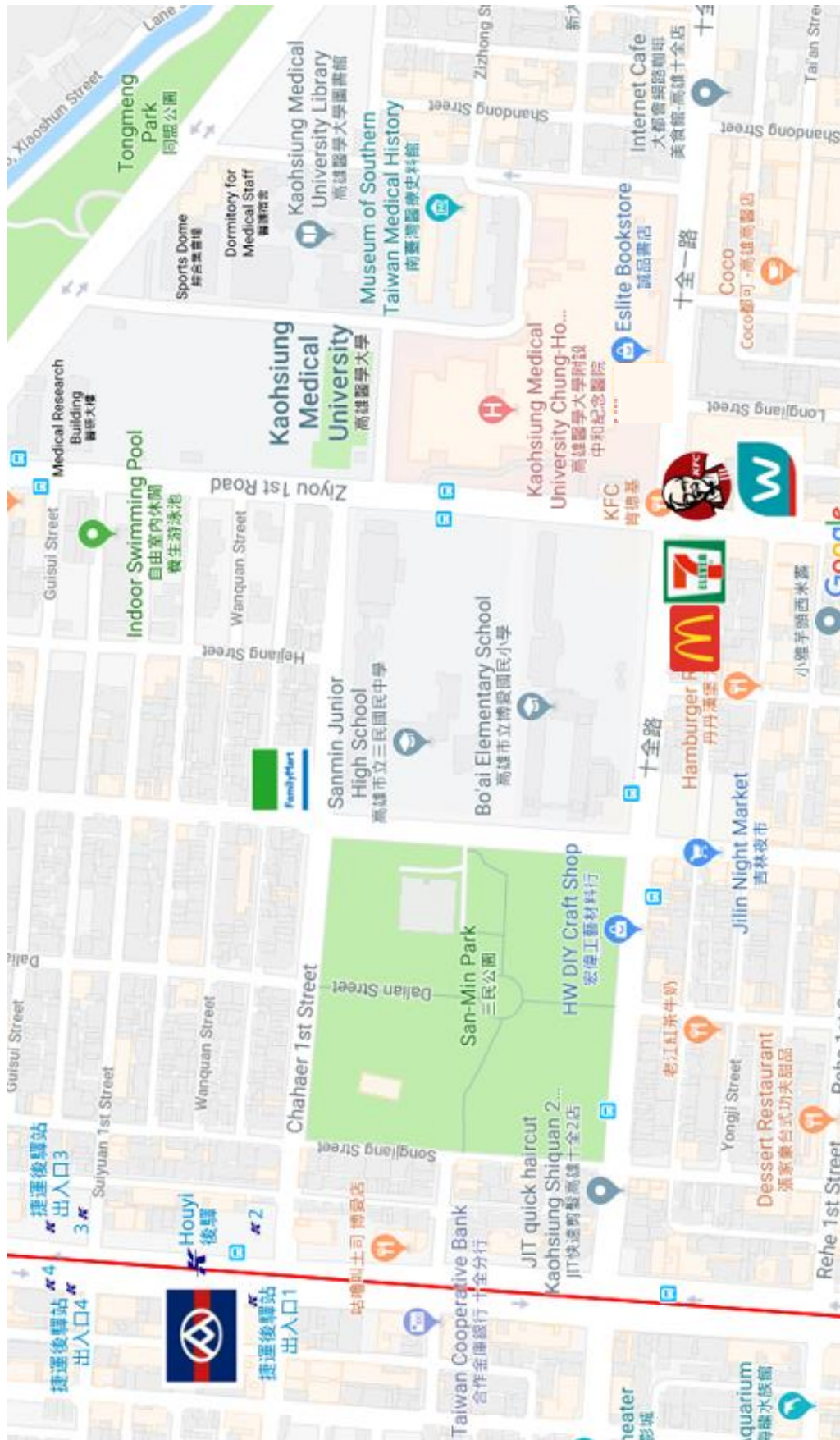



ACADEMIC CALENDER

Kaohsiung Medical University 2020-2021 Academic Calendar										
Year	Month	Monthly Calendar							Event	
		Sun	Mon	Tue	Wed	Thu	Fri	Sat		
2020	AUG								1	1 Commencement of 2020 Fall semester
		2	3	4	5	6	7	8	3 Student health examination and registration for Post Baccalaureate Medicine New graduate students registration and review academic credentials	
		9	10	11	12	13	14	15	13 Preliminary course selection begins (ends on August 26)	
		16	17	18	19	20	21	22	24 Tuition/miscellaneous fees reductions for students ends 26 Preliminary course selection ends, Due day of tuition/miscellaneous fees application to bank	
		23	24	25	26	27	28	29	Due day of payment for postponing tuition and fees (for students of government scholarships for fostering local medial talent/ department of medicine)	
		30	31						28-31 Freshman and transfer students health examination	
	SEP									28-30 Freshman report to dormitories
				1	2	3	4	5	29 Family orientation for freshman	
		6	7	8	9	10	11	12	31 Freshman and transfer students registration, First stage course-adding/drop begins	
		13	14	15	16	17	18	19	1 Opening ceremony	
		20	21	22	23	24	25	26	1-4 Welcome orientation of fall semester (including No.0 mile activity)	
		27	28	29	30				4 Summer vacation ends, Registration ends, Application for return to school ends First stage course-adding/drop ends (till 12:00 noon) , Second stage course-adding/drop begins (20:00 p.m.)	
	OCT					1	2	3	7 Fall semester classes begins, First day of school	
		4	5	6	7	8	9	10	Application for assessment of doctoral candidate qualification begins (for graduate student)	
		11	12	13	14	15	16	17	Application for master's thesis examination begins	
		18	19	20	21	22	23	24	Application for English graduation threshold begins	
		25	26	27	28	29	30	31	Beginning of application for postponing military training (R.O.C. male students Only)	
									14 Second stage course-adding/drop ends (till 12:00 noon)	
	NOV								18 Application for credit transfer ends (only for freshman and transfer students)	
		1	2	3	4	5	6	7	Application for assessment of doctoral candidate qualification ends (for graduate student)	
8		9	10	11	12	13	14	Application for postponing military training ends (R.O.C. male students Only)		
15		16	17	18	19	20	21	21 National Prevention Day for Earthquake Drill		
22		23	24	25	26	27	28	26 Make-up work/class (Adjust holiday on Friday, October 2)		
29		30								
DEC			1	2	3	4	5	1 Moon Festival (holiday)		
	6	7	8	9	10	11	12	The second year of Ph.D degree maintain the list of advisor online (ends on October 31)		
	13	14	15	16	17	18	19	Anniversary of Kaohsiung Municipal Chijin Hospital		
	20	21	22	23	24	25	26	9 Extendy Holiday		
	27	28	29	30	31			10 The National Day (holiday)		
								16 University Anniversary (no class), Classes should reach one-third of this semester		
2021	JAN								30 Last day to apply for master's thesis examination	
									2-6 Midterm examination (Ninth week of the semester)	
		3	4	5	6	7	8	9	16 Anniversary of Kaohsiung Municipal Hsiaokang Hospital	
		10	11	12	13	14	15	16	27 Classes should reach two-thirds of this semester	
		17	18	19	20	21	22	23	31 Announcement for the number of people to department transfer temporarily	
		24	25	26	27	28	29	30	Due day for drop-out application	
31							Due day for application of English graduation threshold			





2020-2021 Registration Guide Kaohsiung Medical University, Taiwan

Kaohsiung Medical University 2020-2021 Academic Calendar									
Year	Month	Monthly Calendar						Event	
		Sun	Mon	Tue	Wed	Thu	Fri		Sat
2021	FEB		1	2	3	4	5	6	1 Commencement of 2021 Spring semester 5 Preliminary course selection ends 6 Make-up workday (Adjust holiday on Wednesday, February 10) 8 First stage course-adding/drop begins 10 Adjust holiday 11-16 Chinese New Year Holidays (From Feb. 11, Chinese New Year's Eve, to Feb. 16, the 5th day of Chinese New Year) 15-16 Extendy holiday 17 Tuition/miscellaneous fees reductions for students ends 19 Winter vacation ends, Registration ends, Application for return to school ends First stage course-adding/drop ends (till 12:00 noon) · Second stage course-adding/drop begins (20:00 p.m.) Due day of payment for tuition/miscellaneous fees to bank, Tuition/miscellaneous fees reductions for students ends Due day of application for postponing tuition and fees (for students of government scholarships for fostering local medial talent / department of medicine)
		7	8	9	10	11	12	13	22 Spring semester begins, First day of school, Application for doctoral candidate assessment begins (for master students) Application for master's thesis examination begins, Application for English graduation threshold begins 28 Peace Memorial Day (holiday)
		14	15	16	17	18	19	20	
		21	22	23	24	25	26	27	
		28							
	MAR	Sun	Mon	Tue	Wed	Thu	Fri	Sat	1 Extendy holiday 2 The first year of master's degree maintain the list of advisor online begins (ends on March 31) Second stage course-adding/drop ends (12:00 noon) 8 Application for the assessment of doctoral candidate qualification ends (for graduate student) 26 Announcement for summer session information, Anniversary of Kaohsiung Municipal Tatung Hospita 31 The first year of master's degree maintain the list of advisor online ends
			1	2	3	4	5	6	
		7	8	9	10	11	12	13	
		14	15	16	17	18	19	20	
		21	22	23	24	25	26	27	
	28	29	30	31					
	APR	Sun	Mon	Tue	Wed	Thu	Fri	Sat	1 Application for Award of Four Education begins 2 Extendy holiday, Classes should reach one-third of this semester 4 Children's Day, Tomb Sweeping Day (holiday) 5 Extendy holiday 16 Due day of seminar paper posted by graduating students online, Application for master's thesis examination ends 19 Announcement for department transfer 20 Application for Award of Four Education ends, 19-23 Mid-term examination period (Ninth week of the semester)
						1	2	3	
		4	5	6	7	8	9	10	
		11	12	13	14	15	16	17	
		18	19	20	21	22	23	24	
	25	26	27	28	29	30			
	MAY	Sun	Mon	Tue	Wed	Thu	Fri	Sat	14 Last class for undergraduate senior students, Classes should reach two-thirds of this semester 17-21 Final examination period for undergraduate senior students 22 Orientation for undergraduate senior students
								1	
		2	3	4	5	6	7	8	
		9	10	11	12	13	14	15	
		16	17	18	19	20	21	22	
	23	24	25	26	27	28	29		
	30	31							
	JUN	Sun	Mon	Tue	Wed	Thu	Fri	Sat	5 Graduation Ceremony 14 Dragon Boat Festival (holiday) 16 Anniversary of Kaohsiung Medical University Municipal Chungho Hospital 18 Due day for drop-out application, Application for English graduation threshold ends 21-25 Final examination period (The last week of the semester) 28 Summer vacation begins
				1	2	3	4	5	
		6	7	8	9	10	11	12	
		13	14	15	16	17	18	19	
20		21	22	23	24	25	26		
27	28	29	30						
JUL	Sun	Mon	Tue	Wed	Thu	Fri	Sat	19 Tuition/miscellaneous fees reductions for students begins Beginning of student loan application 31 Spring semester ends Examination for master's thesis ends Assessment of doctoral candidate qualification ends	
					1	2	3		
	4	5	6	7	8	9	10		
	11	12	13	14	15	16	17		
	18	19	20	21	22	23	24		
25	26	27	28	29	30	31			

